



10 HOUR CERTIFIED LANDFILL OPERATOR TRAINING

DATE: **MAY 22, 2012**

TIME: **7:00 A.M. – 5:00 P.M.**

LOCATION: **BARKER LEMAR ENGINEERING CONSULTANTS**
 1801 INDUSTRIAL CIRCLE
 WEST DES MOINES, IA 50265
 515-256-8814

SUMMARY:

The 10-Hour Landfill Operator Training has been designed to count as part of a certified landfill operator's 10 contact hours of continuing education as required in the Iowa Administrative Code. This training is designed to assist landfill operators, including management, meet regulatory requirements as well as increase their working knowledge of specific systems that are part of a sanitary landfill operation. The Barker Lemar 10-Hour Landfill Operator Training program provides a thorough overview and understanding of the topics listed below:

- Regulatory Changes/Proposed Changes/Legislative Priorities
- Groundwater Monitoring – SSIs
- SCADA (Supervisory Controls and Data Acquisitions) Systems
- Load checking
- Safety
- Disaster Debris Management
- Erosion Control at Landfill
- Working Face and Cell Sequencing with Boundary Control
- The Green Movement and its Impact on Landfills
- Zero Waste

CANCELLATION POLICY:

- Registrations cancelled more than 10 days prior to a scheduled class are fully refundable.
- Registrations cancelled within 10 days prior to a scheduled class, including no-shows, are not refundable.
- If a class is cancelled for any reason, you will receive, at your option, either a full refund of fees paid or full credit for fees paid toward registration in any future class offered.
- Classes cancelled for inclement weather will be rescheduled. Class participants will be notified of the new date within 5 business days.
- Classes cancelled for not meeting minimum participation levels will be cancelled 4 business days prior to the scheduled class date.

Questions concerning the above policy or any other issues surrounding training classes should be directed to: Donna Jackson, djackson@barkerleamar.com, or 515-256-8814.

1801 INDUSTRIAL CIRCLE
WEST DES MOINES, IA 50265

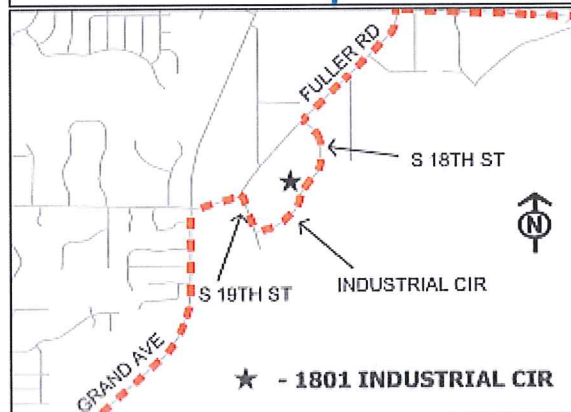

From Interstate 35

Take the GRAND AVE EAST exit (exit # 60A)
Merge onto GRAND AVE.
Turn RIGHT onto FULLER RD.
Turn RIGHT onto S 19TH ST.
Turn LEFT onto INDUSTRIAL CIR.
We are on the LEFT side of the street.

From Interstate 235

Take the IA-28/63RD STREET exit (exit # 4)
Go South IA-28/63RD ST/1ST ST.
Turn RIGHT onto RAILROAD AVE.
Turn LEFT onto FULLER RD.
Turn LEFT onto S 18TH ST.
We are on the RIGHT side of the street.