



## 25 HOUR CERTIFIED LANDFILL OPERATOR TRAINING

**DATE:**            **NOVEMBER 13 - 15, 2012**

**TIME:**            **8:00 AM – 5:00 PM**

**LOCATION:**       **BARKER LEMAR ENGINEERING CONSULTANTS**  
**1801 INDUSTRIAL CIRCLE**  
**WEST DES MOINES, IA 50265**  
**515-256-8814**

### **SUMMARY:**

The Barker Lemar 25-Hour Landfill Operator Training three-day course covers course topics required under state regulations. The training course provides an overview of certain facets of landfill operations and is designed to prepare participants for the sanitary landfill operator certification exam provided by the Iowa Department of Natural Resources (IDNR). This class will not discuss machinery operations, machinery safety, transfer station, or compost operations. The three-day course outline is as follows:

- Definitions: Types of Waste
- Iowa Administrative Code
- Comprehensive Plans and Permits
- Chapter 113 History & Updates
- Geology / Hydrology
- Landfill Siting
- Pre-test One
- Alternative Daily Cover
- Air Space Management
- Waste Decomposition
- Leachate Collection & Control
- Landfill Gas
- Environmental Monitoring
- Pre-test Two
- Engineering & Construction
- Surface Drainage & Erosion Control
- Engineering Plans & Maps
- Survey
- Landfill Operations
- Laws & Regulations
- Policies
- Waste Screening
- Course Summary

### **CANCELLATION POLICY:**

- Registrations cancelled more than 10 days prior to a scheduled class are fully refundable.
- Registrations cancelled within 10 days prior to a scheduled class, including no-shows, are not refundable.
- If a class is cancelled for any reason, you will receive, at your option, either a full refund of fees paid or full credit for fees paid toward registration in any future class offered.
- Classes cancelled for inclement weather will be rescheduled. Class participants will be notified of the new date within 5 business days.
- Classes cancelled for not meeting minimum participation levels will be cancelled 4 business days prior to the scheduled class date.

Questions concerning the above policy or any other issues surrounding training classes should be directed to: Donna Jackson, [djackson@barkerlemar.com](mailto:djackson@barkerlemar.com), or 515-256-8814.

1801 INDUSTRIAL CIRCLE  
WEST DES MOINES, IA 50265

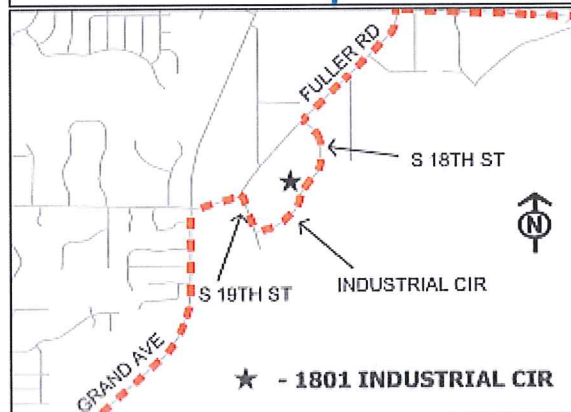

**From Interstate 35**

Take the GRAND AVE EAST exit (exit # 60A)  
Merge onto GRAND AVE.  
Turn RIGHT onto FULLER RD.  
Turn RIGHT onto S 19TH ST.  
Turn LEFT onto INDUSTRIAL CIR.  
We are on the LEFT side of the street.

**From Interstate 235**

Take the IA-28/63RD STREET exit (exit # 4)  
Go South IA-28/63RD ST/19TH ST.  
Turn RIGHT onto RAILROAD AVE.  
Turn LEFT onto FULLER RD.  
Turn LEFT onto S 18TH ST.  
We are on the RIGHT side of the street.