



IOWA DISCARDED APPLIANCE DEMANUFACTURING TRAINING

DATE: **OCTOBER 16, 2012**

TIME: **8:00 A.M. – 3:00 P.M.**

LOCATION: **BARKER LEMAR ENGINEERING CONSULTANTS**
 1801 INDUSTRIAL CIRCLE
 WEST DES MOINES, IOWA 50265

SUMMARY:

The Appliance Demanufacturing Training class covers topics required under state of Iowa regulations for those who want to be certified appliance demanufacturers. The Barker Lemar Appliance Demanufacturing Training program provides a thorough overview and understanding of the topics listed below:

- Proper removal and management of refrigerants
- PCB capacitors, and mercury components
- Proper methods for loading and unloading discarded appliances
- Identification and removal of asbestos from appliances
- Spill prevention and appliance cleanup procedures

The course outline is as follows:

- Course introduction
- Definition and terminology
- Review of state and federal rules
- Finding and identifying components
- Safety tips
- Spill prevention/spill cleanup tips
- Helpful management tips
- Evaluation form

CANCELLATION POLICY:

- Registrations cancelled more than 10 days prior to a scheduled class are fully refundable.
- Registrations cancelled within 10 days prior to a scheduled class, including no-shows, are not refundable.
- If a class is cancelled for any reason, you will receive, at your option, either a full refund of fees paid or full credit for fees paid toward registration in any future class offered.
- Classes cancelled for inclement weather will be rescheduled. Class participants will be notified of the new date within 5 business days.
- Classes cancelled for not meeting minimum participation levels will be cancelled 4 business days prior to the scheduled class date.

Questions concerning the above policy or any other issues surrounding training classes should be directed to: Donna Jackson, djackson@barkerlemar.com, or 515-256-8814.

1801 INDUSTRIAL CIRCLE
WEST DES MOINES, IA 50265

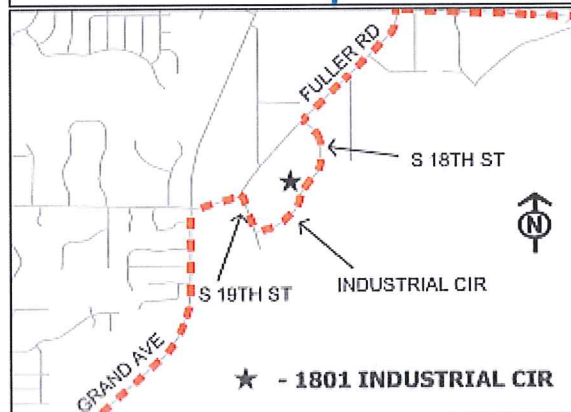

From Interstate 35

Take the GRAND AVE EAST exit (exit # 60A)
Merge onto GRAND AVE.
Turn RIGHT onto FULLER RD.
Turn RIGHT onto S 19TH ST.
Turn LEFT onto INDUSTRIAL CIR.
We are on the LEFT side of the street.

From Interstate 235

Take the IA-28/63RD STREET exit (exit # 4)
Go South IA-28/63RD ST/19TH ST.
Turn RIGHT onto RAILROAD AVE.
Turn LEFT onto FULLER RD.
Turn LEFT onto S 18TH ST.
We are on the RIGHT side of the street.